

TEMPORARY
CONSTRUCTION EXIT

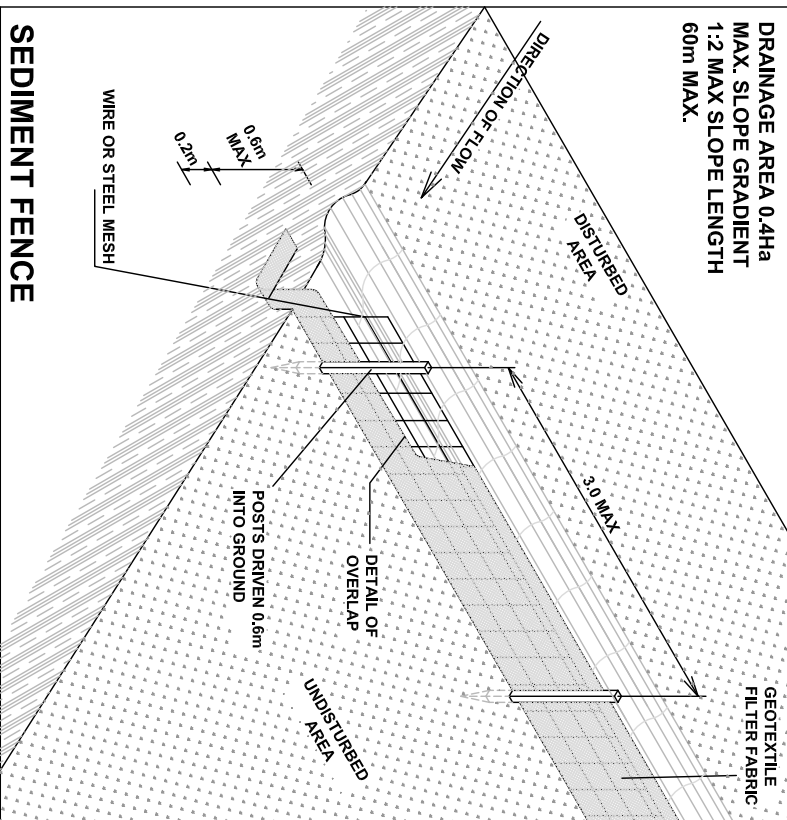

DRAINAGE AREA 0.4ha
MAX. SLOPE GRADIENT
1:2 MAX SLOPE LENGTH
60m MAX.

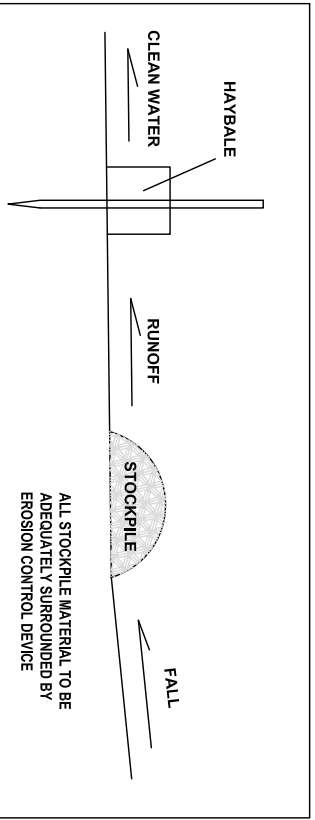

SEDIMENT CONTROL DETAIL

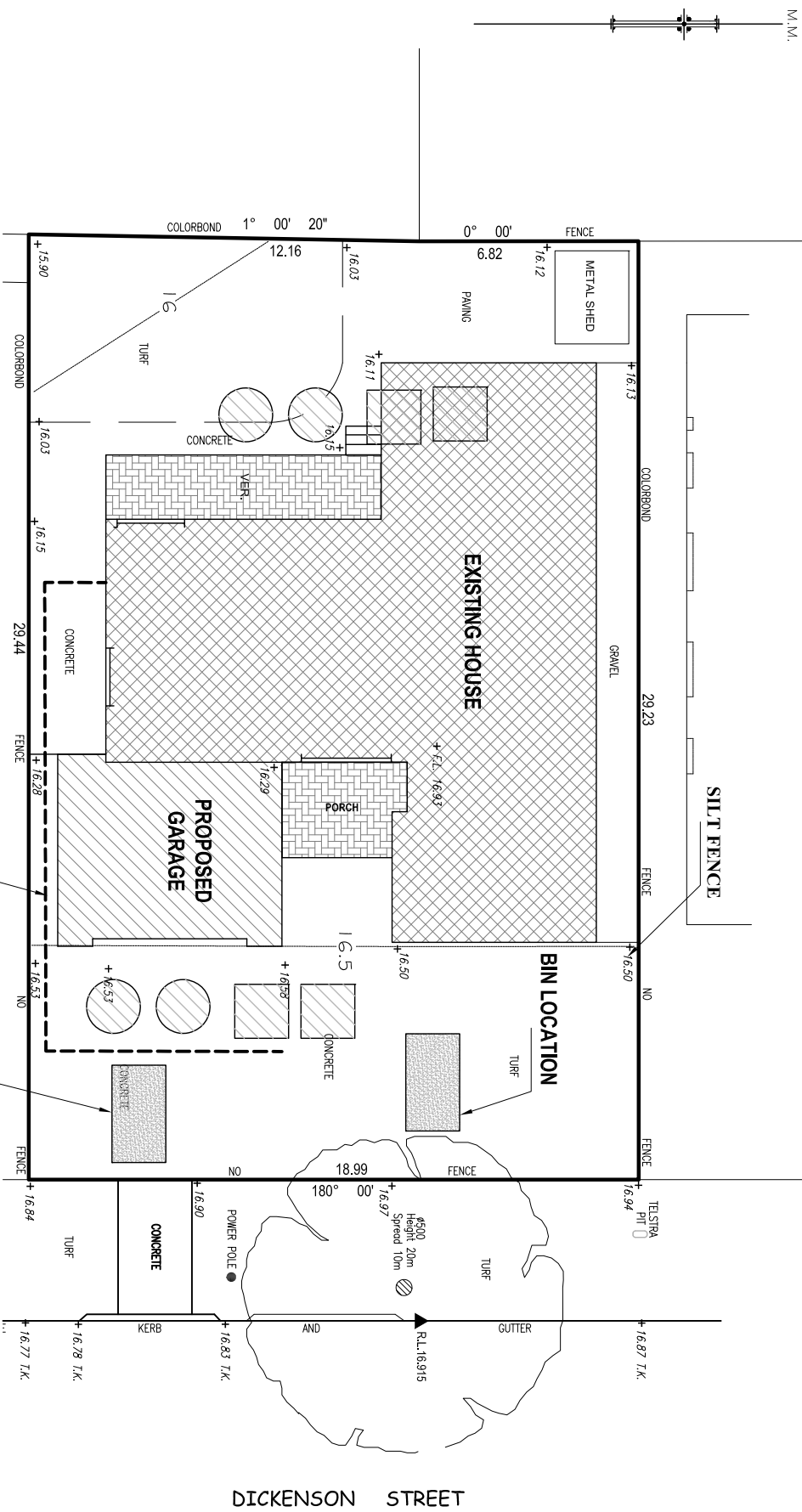

- STICKBALL MATERIALS
- MATERIAL STORAGE AREA
- SOIL STABILIZER

EROSION CONTROL NOTES

- 1-ALL EROSION AND SEDIMENT CONTROL MASUREES ARE TO BE INSTALLED AND MAINTAINED IN ACCORDANCE WITH "MANAGING URBAN STORM-WATER 3RD EDITION" PRODUCED BY THE NEW DEPARTMENT OF HOUSING
- 2-ALL EROSION AND SILTAION CONTROL DEVICES ARE TO BE PLACED PRIOR TO THE COMMENCEMENT OF ANY CONSTRUCTION WORK AND ALL SILT TRPS ATRE TO HAVE DEPOSITED SILT REMOVED REGULARLY DURING CONSTRUCTION
- 3-ALL TREES ARE TO BE PRESERVED UNLESS INDICATED OTHERWISE ON THE ARCHITECTS OR LANDSCAPE ARCHITECTS DRAWING. EXISTING GRASS COVER SHALL BE MAINTAINED EXCEPT IN AREAS CLEARED FOR BUILDING PAVEMENTS ETC.
- 4-INSTALL TEMPORARY SEDIMENT BARRIERS T O ALL LINELET PITS LIKELY TO COLLECT SILT LADDEN WATER
- 5-NNOT WITHSTANDING DETAILS SHOW IT IS THE CONTRACTORS SOLE RESPONSIBILITY TO ENSURE THAT ALL SITE ACTIVITIES COMPLY WITH THE REQUIREMENTS OF THE CLEAN WATER ACT.

Plan No	Date	Issue No	Scale	Sheet No	OWNER: Mr	PROPOSED ALTERATION AND ADDITION
189/23	18/09/2023	A	1: 200	9	RAFLA ARCH	SITE: 20 DICKENSON ST PANANIA
					Architectural design	PH: 0409 701 575
						Site: EROSION CONTROL PLAN
Rev.	Date	Description			Email:rafla.arch@bigpond.com	COUNCIL: CANTERBURY BANKSTOWN CITY COUNCIL
A	18/09/2023	DA APPLICATION				